

Connect2Work

**Setup your
corporate device**



Please read before enrolment!



Remove the phone and charger from the box and begin charging the phone as the device's battery is unlikely to be fully charged. The enrolment process can be performed while the device is charging.



The enrolment process may take between 15-30 mins and requires access to mobile internet data. This can be done using the 3G / 4G / 5G data on the SIM card. Please do not use the Endeavour Foundation Corporate or Guest WiFi.



As part of EF's data security measures, you will be required to setup an access (PIN) code for the device. You will need to nominate a 4 digit code during the process.

Whilst these instruction steps are for new Apple iPhone devices, they can be loosely followed for other older Apple devices issued by EF



You will need to enter your username and password a few times when prompted. This is normally your Endeavour Foundation email address but contact ICT Service Desk on 1300 742 212 to confirm if you are unsure!

Step by Step Instructions

Need assistance? Contact ICT Helpdesk on 1300 742 212

Step	Instructions
1	Press 'Home' to open
2	Select your preferred language
3	Under 'Select Your Country or Region', tap 'Australia'
4	Under 'Quick Start' tap 'Set Up Manually'
5	When it asks you to choose a Wi-Fi Network scroll down and tap 'Use Mobile Connection' or 'Continue without Wi-Fi'
6	Under 'Data & Privacy' review the information and tap 'Continue'
7	Under 'Apps & Data' tap 'Don't Transfer Apps & Data'
8	Review the information on the 'Remote Management' screen and tap 'Next'
9	Choose to setup Touch ID now by tapping 'Continue' and following the prompts or tap 'Set Up Touch ID Later' to skip this step
10	Set your 4 Digit Passcode. Please Note - the phone will not accept 1234!
11	The phone will request an Apple ID. You will not be able to use your personal Apple ID. ICT Helpdesk will arrange a work Apple ID for you and Apple will email you the Apple ID and temporary password to enter at this step.
12	Use your new corporate phone number to verify your identity by tapping 'Use +61 4XX XXX XXX'
13	Set a new Apple password
14	On the 'Location Services' screen tap 'Enable Location Services'
15	Choose to setup Siri now by tapping 'Continue' and following the prompts or tap 'Set Up Later in Settings' to skip this step
16	Choose to setup Screen Time now by tapping 'Continue' and following the prompts or tap 'Set Up Later in Settings' to skip this step
17	Under iPhone Analytics choose your option to either 'Share with Apple' or 'Don't Share'
18	Under Appearance select 'Light' or 'Dark' depending on your personal preference and tap 'Continue'
19	The phone will display a message 'Guided Access app unavailable. Please contact your Administrator'. Please leave the phone for a few minutes while it prepares the work profile.
20	Company Portal will appear – tap 'Sign In'

Step by Step Instructions

Need assistance? Contact ICT Helpdesk on 1300 742 212

Step	Instructions
21	Enter your Endeavour Foundation username (could be firstname.surname@endeavour.com.au or lastnameinitial@endeavour.com.au) and tap 'Next'
22	Enter your Endeavour Foundation credentials (username and password) and tap 'Sign In'
23	Complete Multi-Factor Authentication (MFA) step (if applicable)
24	Tap ' Continue ' under 'Set up Endeavour Foundation access'
25	Under 'Allow "Comp Portal" to use your location?' tap ' Allow While Using App '
26	Under 'Choose the best category for this device' tap ' Endeavour Foundation iOS Apple Devices '
27	Tap ' Continue ' under 'Set up Endeavour Foundation access'
28	The screen will show 'You're all set!' so tap ' Done '
29	The phone will now begin to download a few applications
30	Tap ' View all apps ' to scroll through and download any additional applications you require
31	You can remove any applications you don't need by holding down and tapping ' Remove App '

1

Tap **'Home'** to open



2

Select your preferred language



3

Select **'Australia'** as your Country

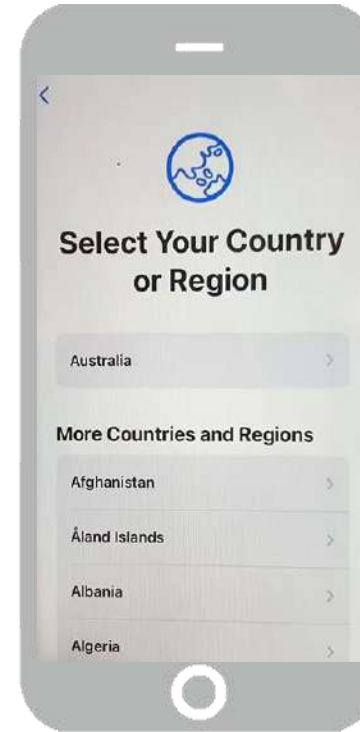

4

Tap **'Set Up Manually'**



5

Tap **'Use Mobile Connection'** or **'Connect without Wi-Fi'**



6

Review the information under **Data & Privacy** and tap **'Continue'**



7

Under **'Apps & Data'** tap **'Don't Transfer Apps & Data'**

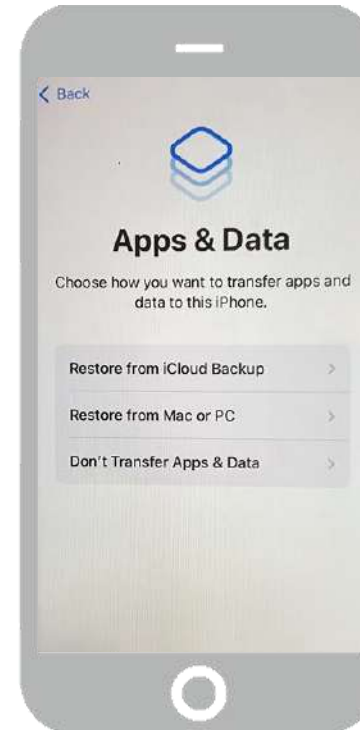

8

Review the information under **'Remote Management'** and tap **'Next'**



9

Tap '**Continue**' to set up Touch ID and follow the prompts or tap '**Set up Touch ID Later**'

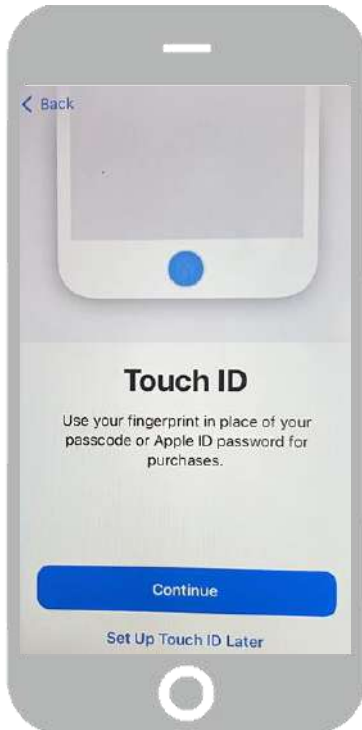

10

Create a passcode



Please note!
Tap '**Passcode Options**'
for different passcode
formats.
1234 will not be accepted

11

The phone will request an Apple ID which ICT have set up for you using your work email address. Use the temporary password sent to you from Apple to log in.

Please contact ICT Support Desk if you do not have this email

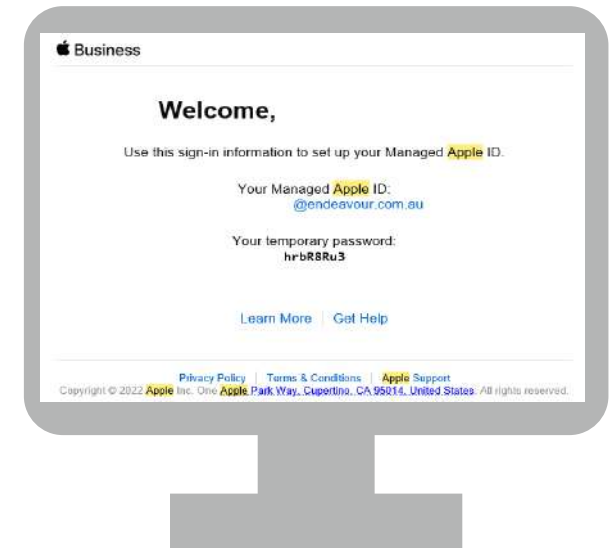

12

Use your corporate phone number to verify your identity



13

Set your new Apple ID Password



14

On the 'Location Services' screen tap **"Enable Location Services"**



15

Tap **'Continue'** to set up Siri and follow the prompts or tap **'Set up Later in Settings'**



16

Choose '**Continue**' if you want to set up *Screen Time* now or if not, tap '**Set up later in Settings**'

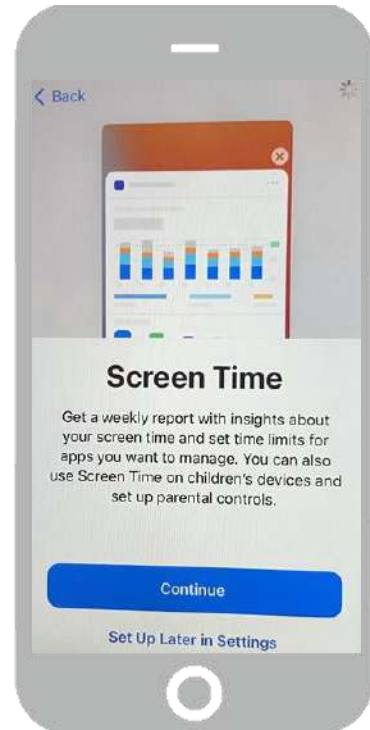

17

Choose '**Share with Apple**' if you want to share your data, if not, tap '**Don't share**'



18

Set your '**Appearance**' preference and tap '**Continue**'

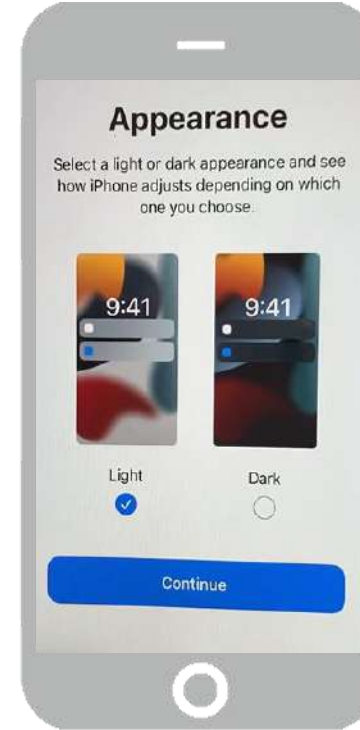

19

The phone will display the below until it prepares your work profile



Please note!
This may take a couple of minutes

20

When Company Portal appears tap 'Sign In'

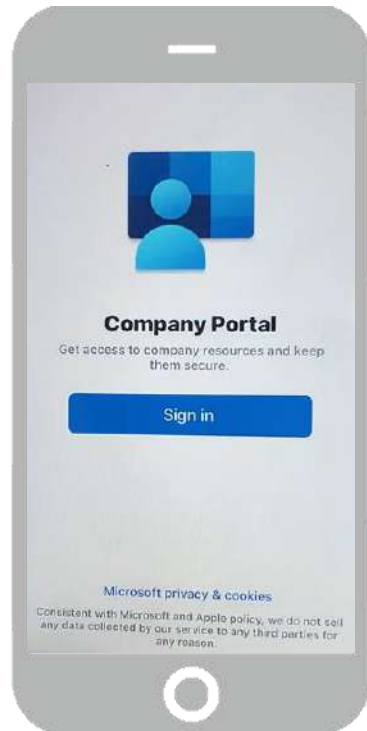

21

Enter your **Endeavour Foundation username** and tap 'Next'



22

Enter your **Endeavour Foundation credentials**

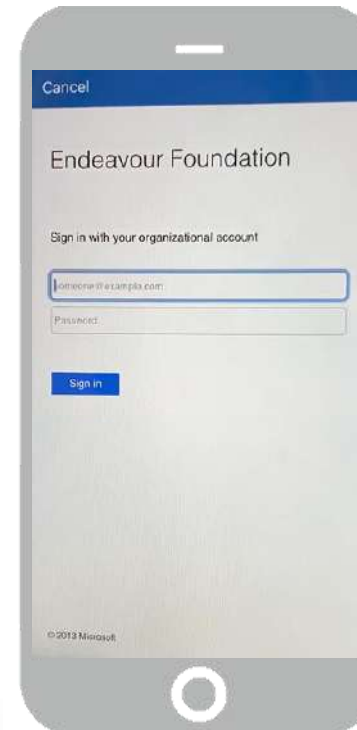

23

Complete the **Multi-Factor Authentication (MFA)** step if applicable



24

Tap **'Continue'** under **'Set up Endeavour Foundation access'**

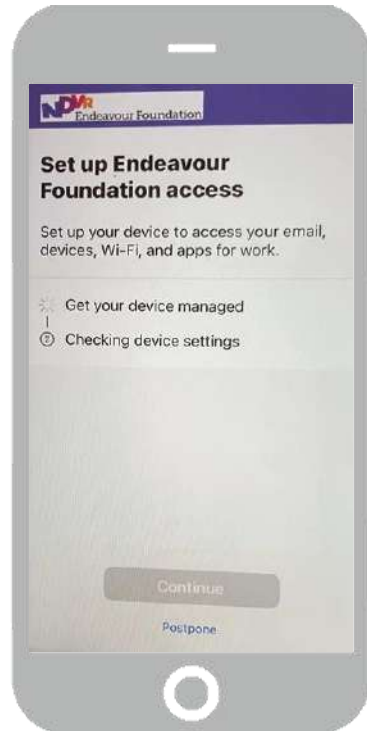

25

Tap **'Allow While Using App'**

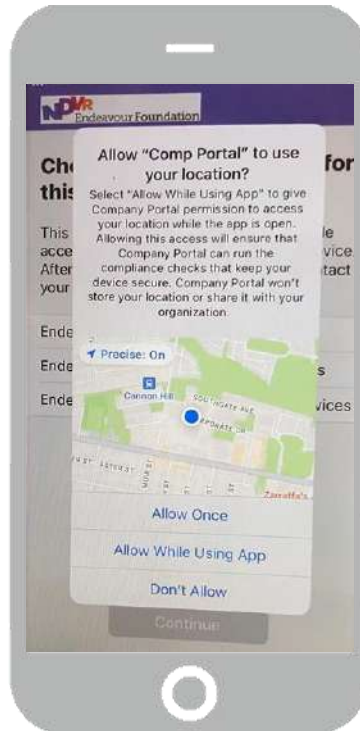

26

Tap **'Endeavour Foundation iOS Apple Devices'** and then **'Continue'**



27

Tap **'Continue'**

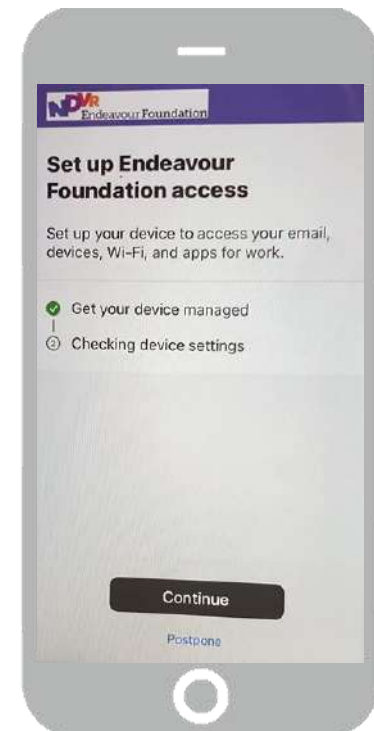

28

The screen will show 'You're all set!' so tap **'Done'**

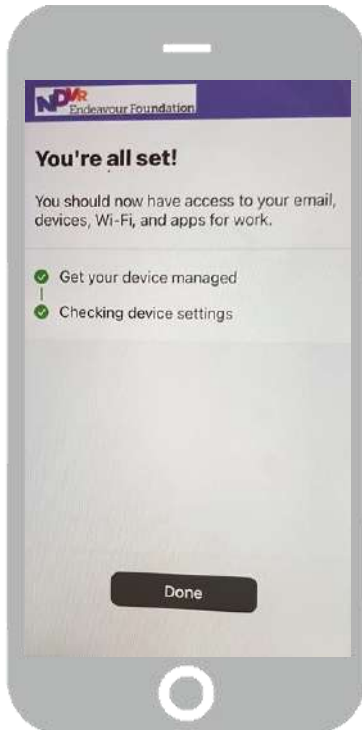

29

The phone will begin to download applications

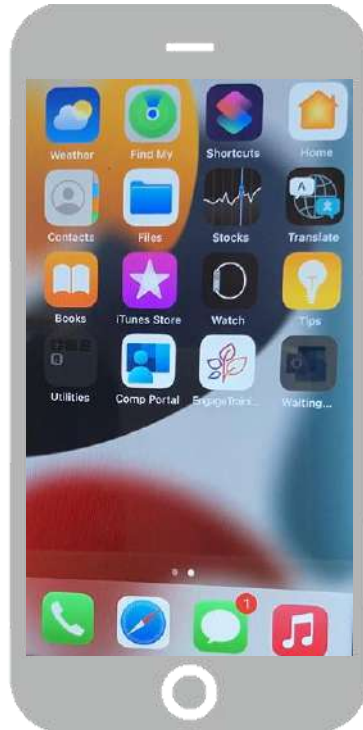

30

Tap **'View all apps'** to download any additional apps you require

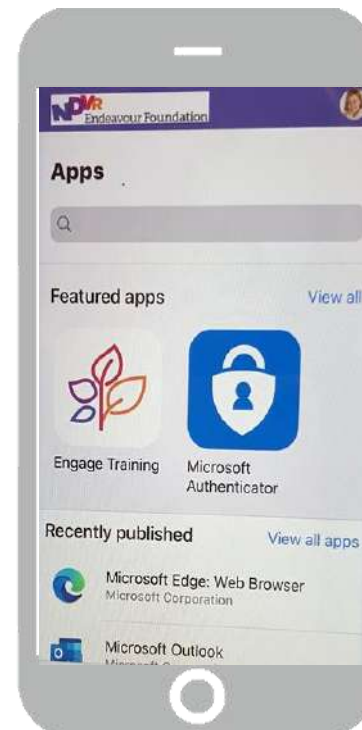

31

You can remove any applications you don't need by holding down and tapping **'Remove App'**

