

# Connect2Work

**Setup your  
house device**



**Android**

# Please read before enrolment!

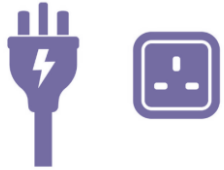

Remove the phone and charger from the box and begin charging the phone as the device's battery is unlikely to be fully charged. The enrolment process can be performed while the device is charging.



The enrolment process may take between 10-15 mins and requires access to mobile internet data. This can be done using the 3G / 4G / 5G data on the SIM card. Please do not use the Endeavour Foundation Corporate or Guest Wi-Fi.

As part of Endeavour Foundation's data security measures, you will be required to setup an access (PIN) code for the device. You will need to nominate a 4-digit code during the process.



While these instruction steps are for new Samsung Android devices, they can be loosely followed for other older Android devices issued by Endeavour Foundation.

# Step by Step Instructions

Need assistance? Contact ICT Helpdesk on 1300 742 212

Step	Instructions
1	Turn on the device and tap <b>'Start'</b>
2	Review and tick each of the Legal Items and tap <b>'Next'</b>
3	<b>'Skip'</b> the Wi-Fi connection to use the data on the SIM card
4	‘This device belongs to your organisation’ screen - tap <b>'Next'</b>
5	‘Set up your phone’ screen - review and tap <b>'Accept &amp; continue'</b>
6	‘This device isn’t private’ - tap <b>'Next'</b>
7	‘Installing work apps...’ screen – tap <b>'Done'</b>
8	Google Services – Review and tap <b>'Accept'</b>
9	Tap <b>'Done'</b> once device is ready to go
10	‘Discover and install great apps’ screen - tap <b>'Later'</b> as you will not be able to download apps outside of Intune default apps
11	The device will start to download work applications – please note, this may take a few minutes. Use Google Play Store to download any additional applications you require

1

Turn on the device and tap '**Start**'

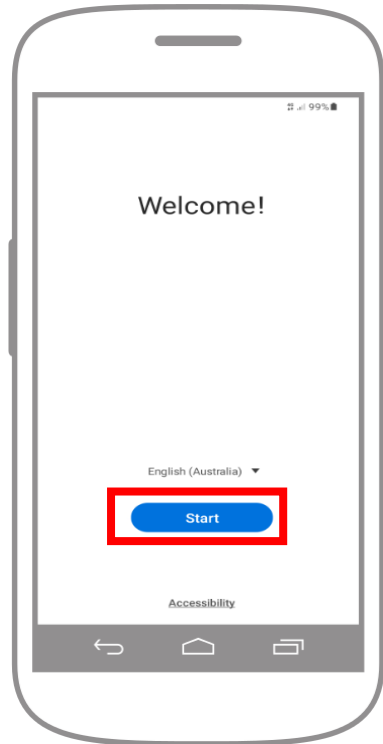

2

Review and tick each of the legal items and tap '**Next**'

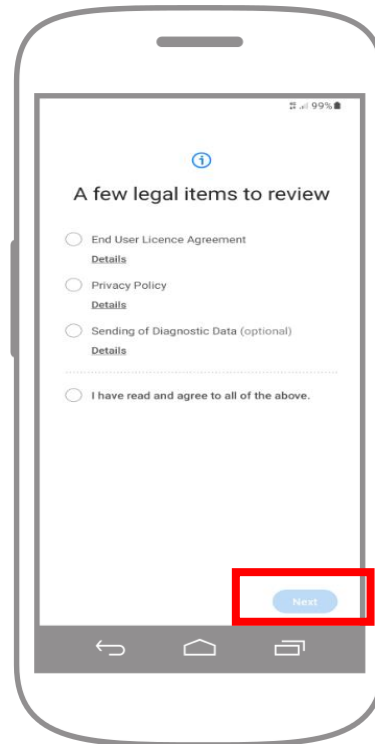

3

'**Skip**' the Wi-Fi Connection to use the data on the SIM

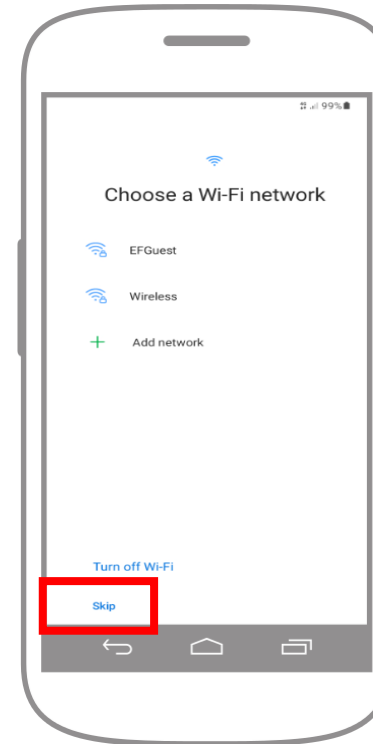

4

Tap '**Next**' on the screen 'This device belongs to your organisation'

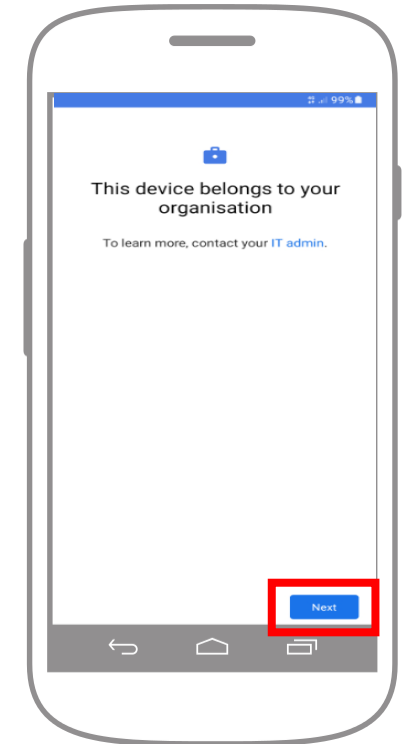

5

Tap '**Accept & continue**' on the screen 'Set up your phone'

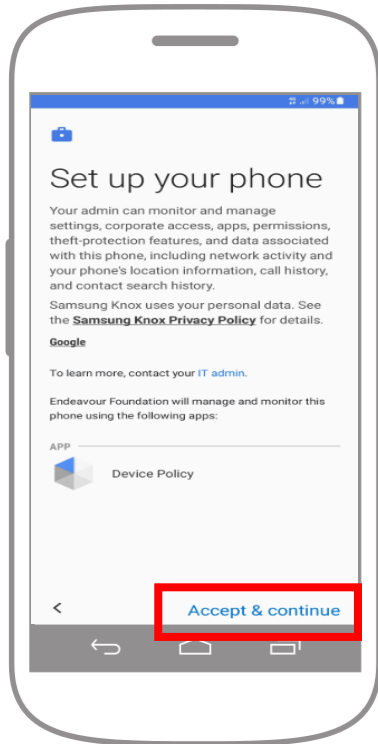

6

Tap '**Next**' on the screen 'This device isn't private'

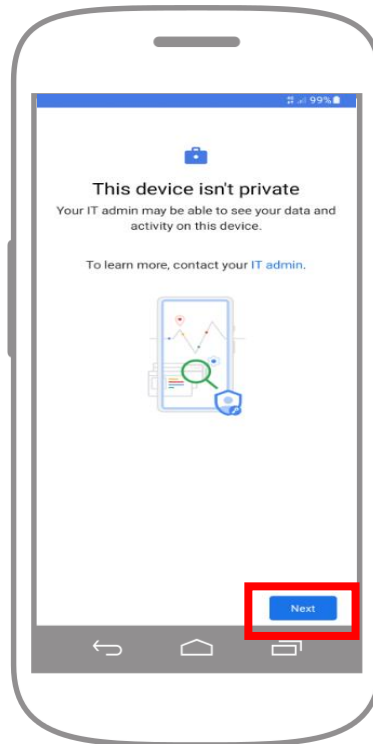

7

Under 'Installing work apps...' tap '**Done**'

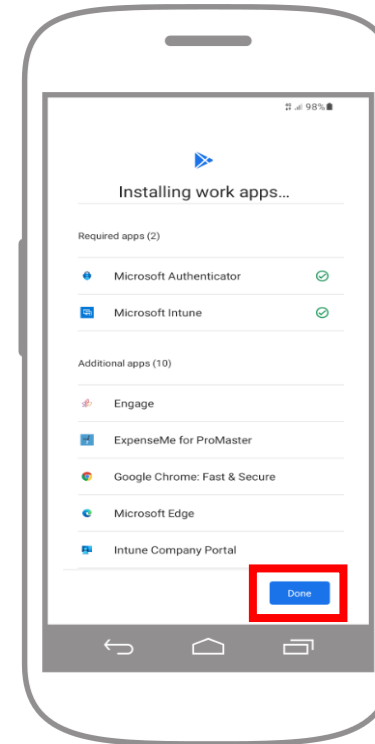

8

Tap '**Accept**' under Google Services

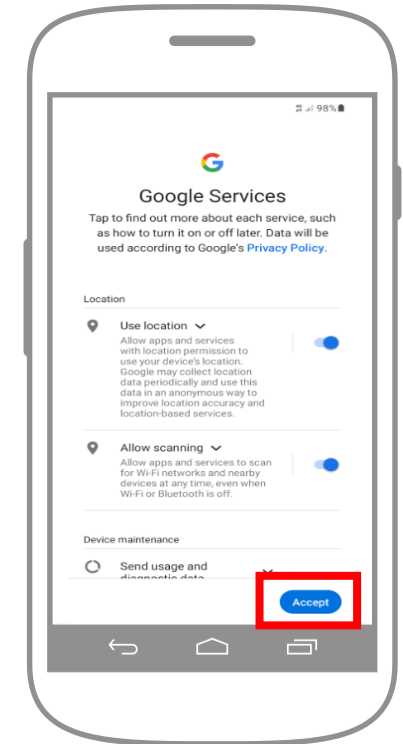

9

Tap '**Done**' once device is ready to go

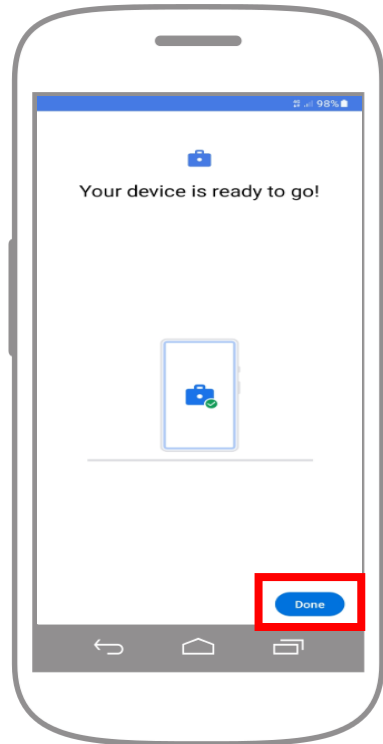

10

Tap '**Later**' on 'Discover and install great apps'

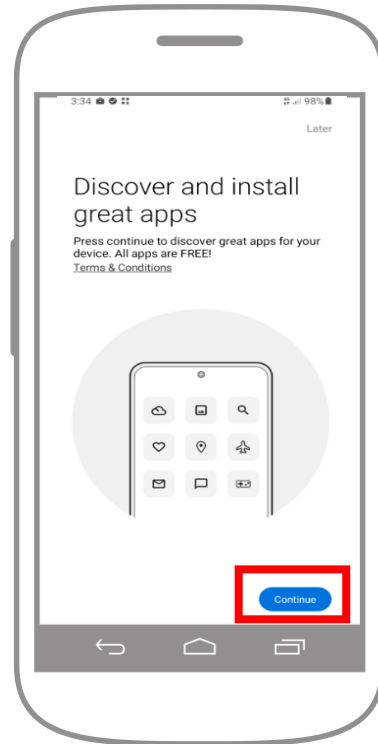

11

Device will start to download work applications – this may take a few minutes!

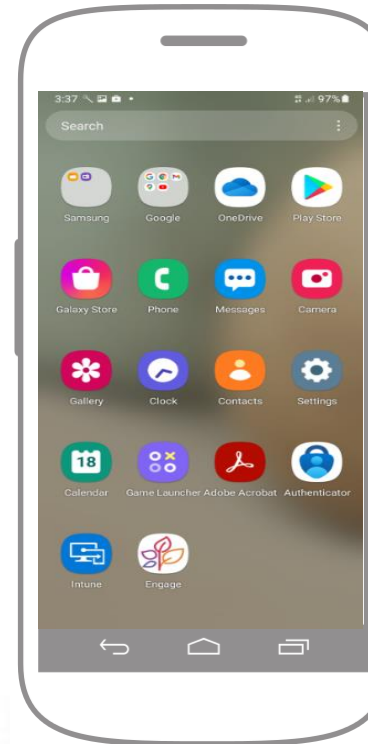

11

Device is now ready to use

